

Threaded Cross Malleable Iron, Class 150 Inches / Pounds

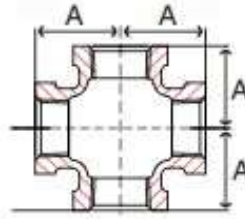

Part #	Size	A (center to end)	Approximate Weight (in Lbs.)
KTC.125MI	1/8	0.56	0.02
KTC.25MI	1/4	0.66	0.02
KTC.375MI	3/8	0.66	0.30
KTC.5MI	1/2	0.75	0.30
KTC.75MI	3/4	0.75	0.60
KTC1MI	1	0.75	1.10
KTC1.25MI	1-1/4	0.84	1.40
KTC1.5MI	1-1/2	0.84	1.90
KTC2MI	2	0.84	2.80
KTC2.5MI	2-1/2	0.84	5.00
KTC3MI	3	1.00	7.30
KTC4MI	4	1.00	12.60

****Malleable iron castings conform to ASTM A197***

****Dimensions conform to ASME B16.3***

****NPT Threads on all fittings conform to ASME B1.20.1***